

# FRONT SUSPENSION ARM SUB-ASSY LOWER NO.1 LH (ATM)

260F7-01

## REPLACEMENT

### HINT:

- COMPONENTS: See page 26-2
- The removal and installation on the lower No.1 RH can be performed without removing the power steering link assy and front suspension cross member.

1. REMOVE FRONT WHEELS
2. REMOVE HOOD SUB-ASSY (See page 75-1)
3. SUSPEND ENGINE ASSY (See page 40-9)

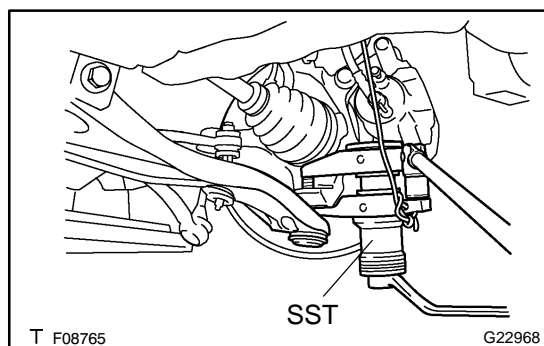

### 4. SEPARATE FRONT SUSPENSION ARM SUB-ASSY LOWER NO.1 LH

- (a) Remove the clip and the nut.
- (b) Using SST, separate the lower suspension arm from the steering knuckle.  
SST 09628-00011

### 5. SEPARATE FRONT SUSPENSION ARM SUB-ASSY LOWER NO.1 RH

SST 09628-00011

### HINT:

Separation of the RH is the same as that of the LH.

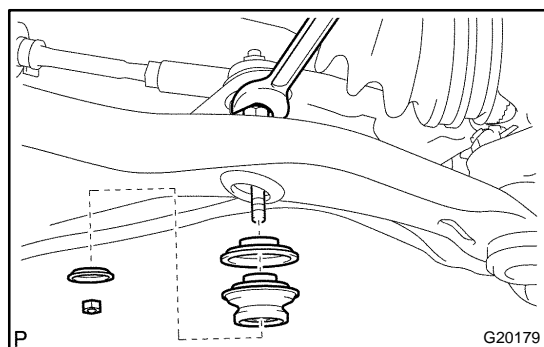

### 6. SEPARATE STABILIZER BAR FRONT

- (a) While holding the front stabilizer bolt with the spanner, remove the nut.
- (b) Remove the 2 retainers and cushion, and then remove the front stabilizer bolt.
- (c) Perform the procedure above on the other side.

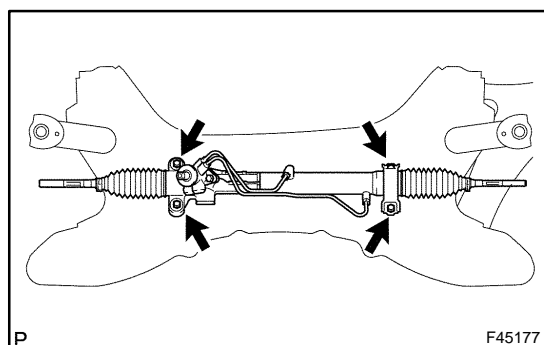

### 7. SEPARATE POWER STEERING LINK ASSY

- (a) Remove the 4 bolts and the 4 nuts, and separate the power steering link assy.

### HINT:

Suspend the power steering link assy.

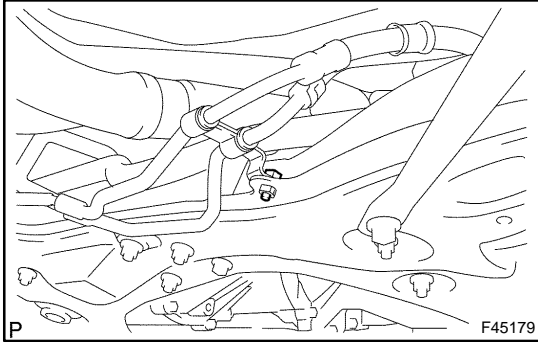
**8. SEPARATE PRESSURE FEED TUBE ASSY**

- (a) Remove the bolt and separate the pressure feed tube assy.

**9. REMOVE FRONT SUSPENSION MEMBER REINFORCEMENT LH**

- (a) Remove the 2 bolts and the front suspension member reinforcement LH.

**10. REMOVE FRONT SUSPENSION MEMBER REINFORCEMENT RH**

- (a) Remove the 2 bolts and the front suspension member reinforcement RH.

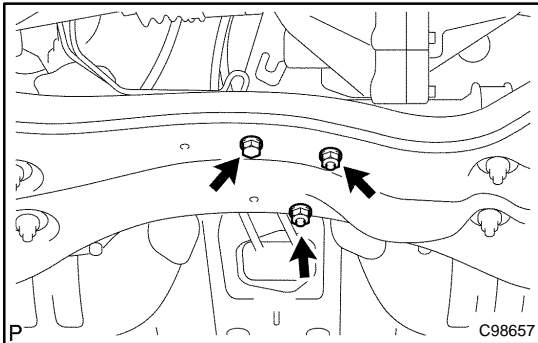
**11. SEPARATE FRONT SUSPENSION CROSSMEMBER SUB-ASSY**

- (a) Remove the bolt and the 2 nuts.

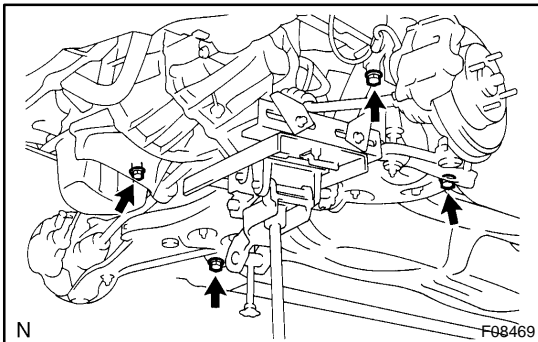

- (b) Support the front suspension crossmember sub-assy with the jack.  
(c) Remove the 4 bolts and separate the front suspension cross member sub-assy.

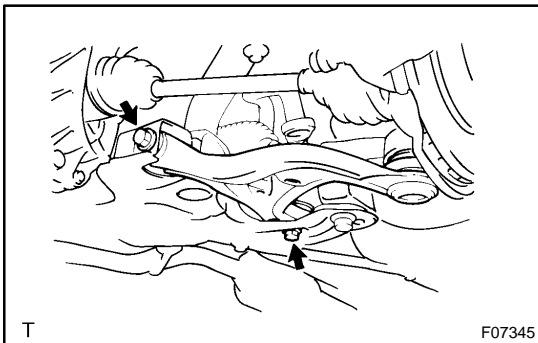
**12. REMOVE FRONT SUSPENSION ARM SUB-ASSY LOWER NO.1 LH**

- (a) Remove the 2 bolts, nut and the front suspension arm sub-assy lower No.1.

**NOTICE:**

**Do not turn the nut.**

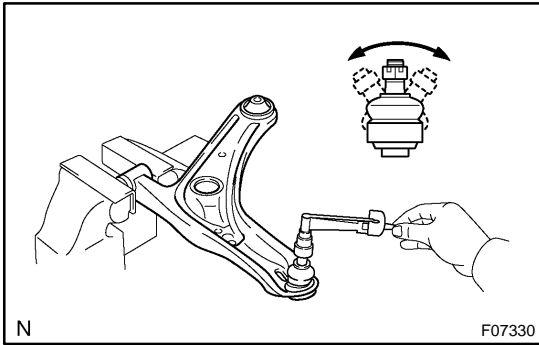

**13. INSPECT FRONT SUSPENSION ARM SUB-ASSY LOWER NO.1 LH**

- (a) As shown in the illustration, flip the ball joint stud back and forth 5 times before installing the nut.
- (b) Using a torque wrench, turn the nut continuously at a rate of 2 to 4 seconds per turn and take the torque reading on the 5th turn.

**Turning torque:**

**5.0 N·m (51 kgf·cm, 44 in.-lbf) or less**

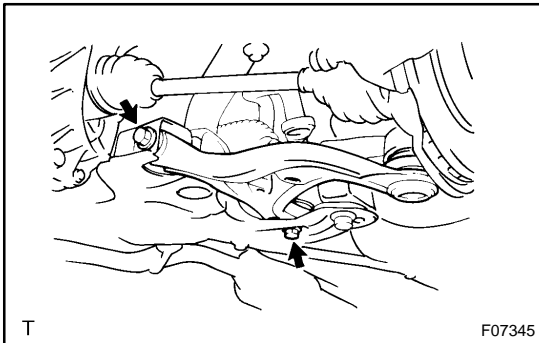

**14. TEMPORARILY TIGHTEN FRONT SUSPENSION ARM SUB-ASSY LOWER NO.1 LH**

- (a) Temporarily tighten the front suspension arm sub-assy lower No.1 LH with the 2 bolts and the nut.

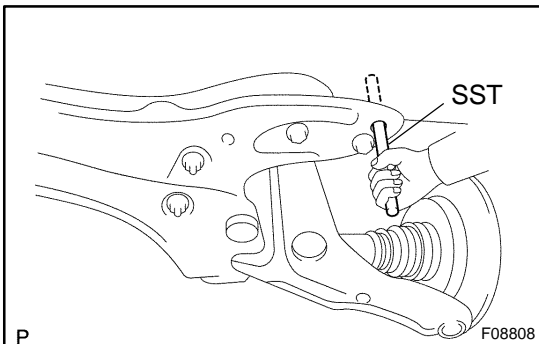

**15. CONNECT FRONT SUSPENSION CROSSMEMBER SUB-ASSY**

- (a) Using SST, align the holes of the suspension member and the body.  
SST 09670-00010
- (b) Perform the procedure above on the other side.

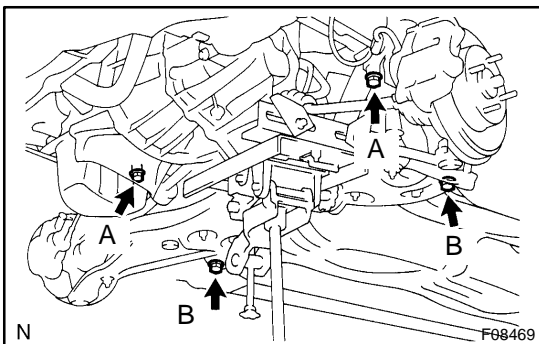

- (c) Install the suspension member with the 4 bolts.

**Torque:**

**Bolt A: 70 N·m (715 kgf·cm, 52 ft·lbf)**

**Bolt B: 116 N·m (1,180 kgf·cm, 86 ft·lbf)**

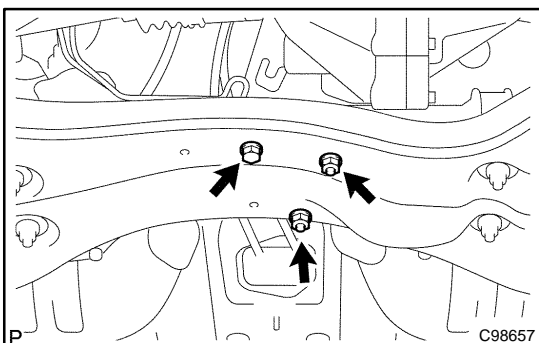

- (d) Install the bolt and the 2 nuts.

**Torque: 80 N·m (816 kgf·cm, 59 ft·lbf)**

**16. INSTALL FRONT SUSPENSION MEMBER REINFORCEMENT LH**

- (a) Install the front suspension member reinforcement LH with the 2 bolts.  
**Torque: 47 N·m (480 kgf·cm, 35 ft·lbf)**

**17. INSTALL FRONT SUSPENSION MEMBER REINFORCEMENT RH**

- (a) Install the front suspension member reinforcement RH with the 2 bolts.  
**Torque: 47 N·m (480 kgf·cm, 35 ft·lbf)**

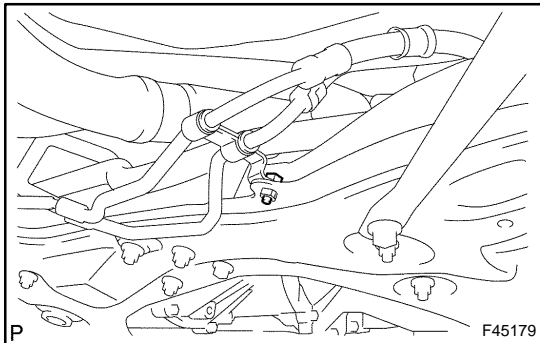
**18. CONNECT PRESSURE FEED TUBE ASSY**

- (a) Connect the pressure feed tube assy with the bolt.  
**Torque: 7.8 N·m (80 kgf·cm, 69 in·lbf)**

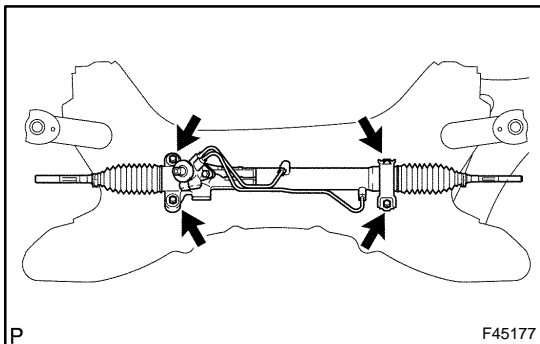
**19. CONNECT POWER STEERING LINK ASSY**

- (a) Install the power steering link assy with the 4 bolts and the 4 nuts.  
**Torque: 74 N·m (755 kgf·cm, 55 ft·lbf)**

**NOTICE:**

Do not turn the nut.

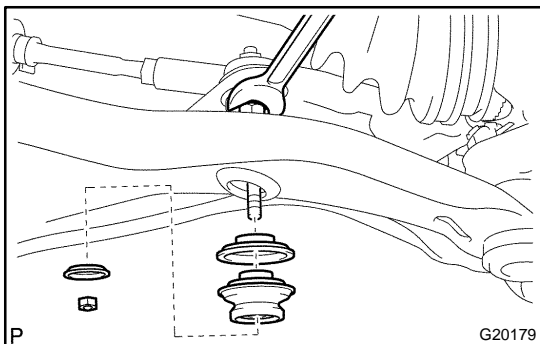
**20. CONNECT STABILIZER BAR FRONT**

- (a) Install the 2 retainers and cushion.  
(b) While holding the front stabilizer bolt with the spanner install the nut.  
**Torque: 18 N·m (180 kgf·cm, 13 ft·lbf)**

**HINT:**

Support the lower arm with the jack.

- (c) Perform the procedure above on the other side.

**21. CONNECT FRONT SUSPENSION ARM SUB-ASSY LOWER NO.1 LH**

- (a) Connect the lower suspension arm to the steering knuckle with the nut.  
**Torque: 98 N·m (1,000 kgf·cm, 72 ft·lbf)**  
(b) Install a new clip.

**NOTICE:**

If the holes for the clip are not aligned, tighten the nut further up to 60°.

**22. CONNECT FRONT SUSPENSION ARM SUB-ASSY LOWER NO.1 RH****HINT:**

Connection of the RH is the same as that of the LH.

**23. INSTALL FRONT WHEELS**

**Torque: 103 N·m (1,050 kgf·cm, 76 ft·lbf)**

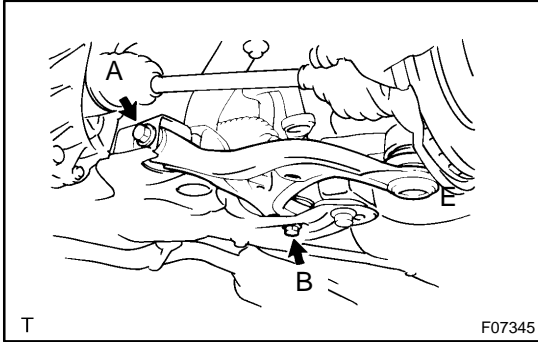

**24. FULLY TIGHTEN FRONT SUSPENSION ARM SUB-ASSY LOWER NO.1 LH**

(a) Fully tighten the front suspension arm sub-assy lower No.1 LH with the 2 bolts.

**Torque:**

**Bolt A: 88 N·m (900 kgf·cm, 65 ft·lbf)**

**Bolt B: 132 N·m (1,350 kgf·cm, 97 ft·lbf)**

**NOTICE:**

**Do not turn the nut.**

**25. INSTALL HOOD SUB-ASSY (See page 75-1)**

**26. INSPECT HOOD SUB-ASSY (See page 75-1)**

**27. ADJUST HOOD SUB-ASSY (See page 75-1)**

**28. INSPECT AND ADJUST FRONT WHEEL ALIGNMENT (See page 26-7)**